

Santa Clara Medical Center

Hospital 700 Lawrence Expressway

Find your department name and number on the list below. Then locate the department number on the floor map above. The first digit indicates the floor number.

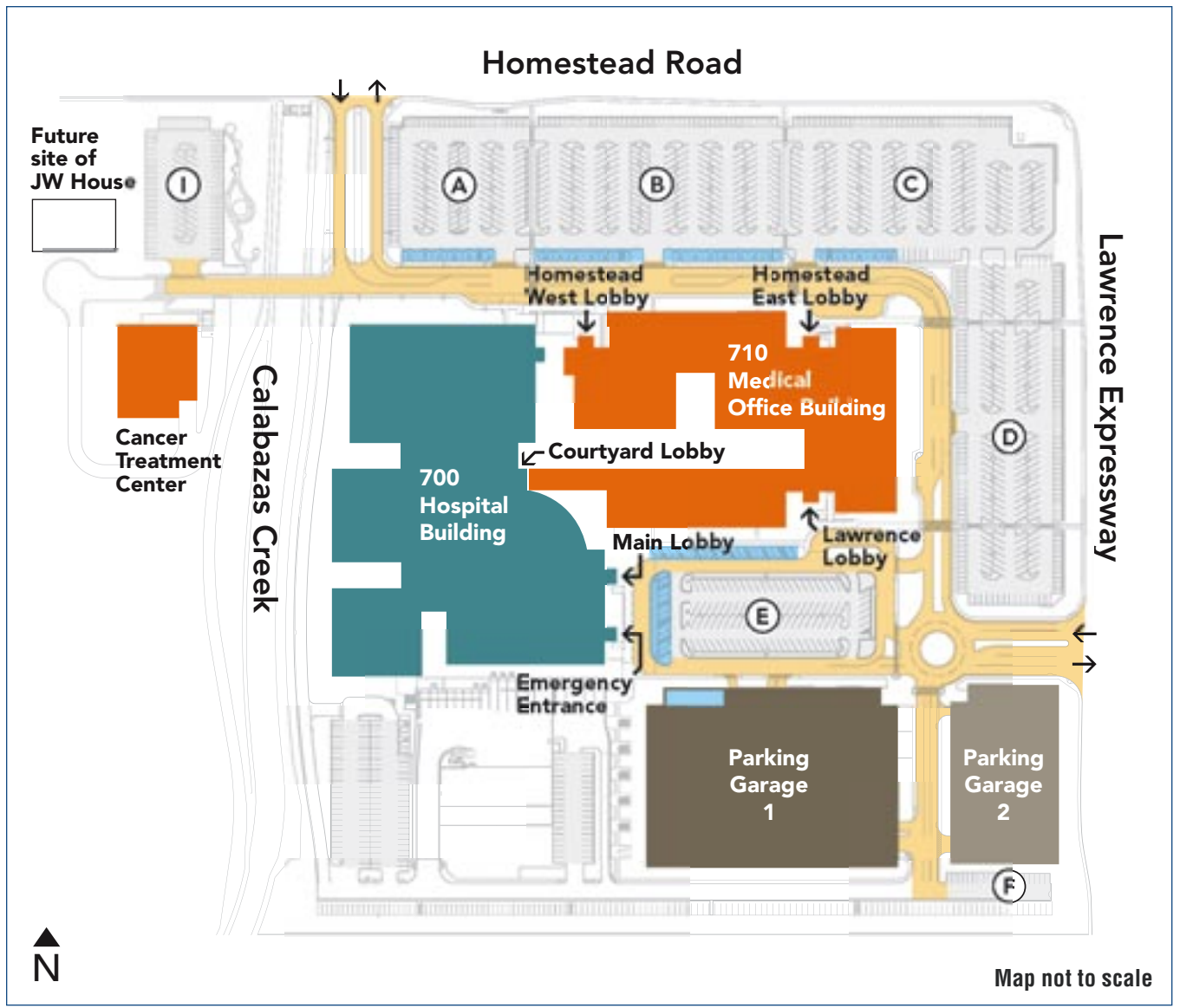

- Hospital Building
- Medical Office Building
- Cancer Treatment Center
- Parking Garage 1
- Parking Garage 2
- Visitor Parking Lots (A B C D E F I)
- Public Driving Route
- Handicapped Parking

Please note, closest parking to Emergency Department is Lot E.

Hospital Floor 1

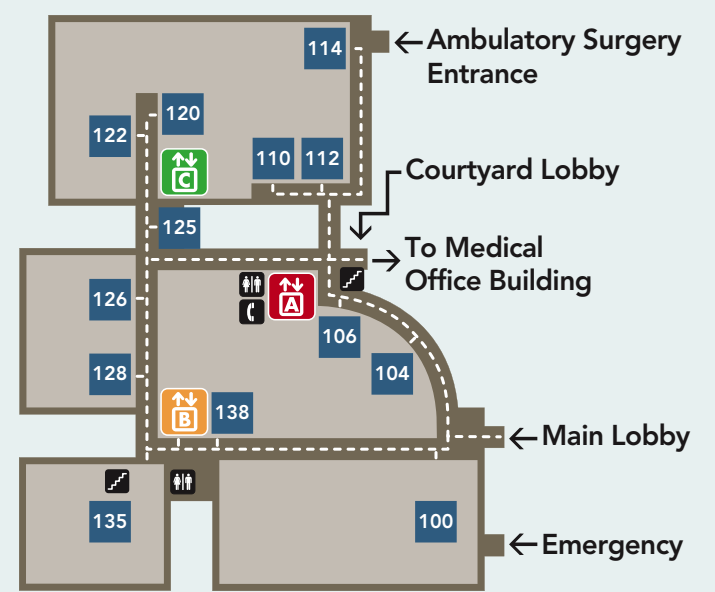

Hospital Floor 2

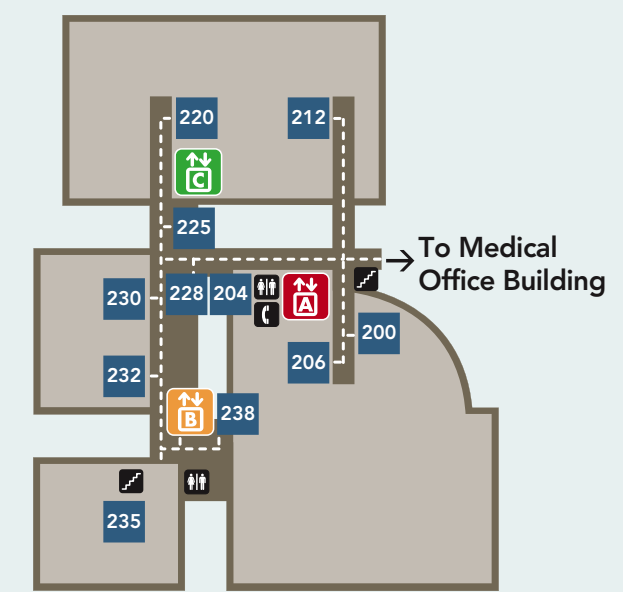

Hospital Floor 3



Hospital Floor 4

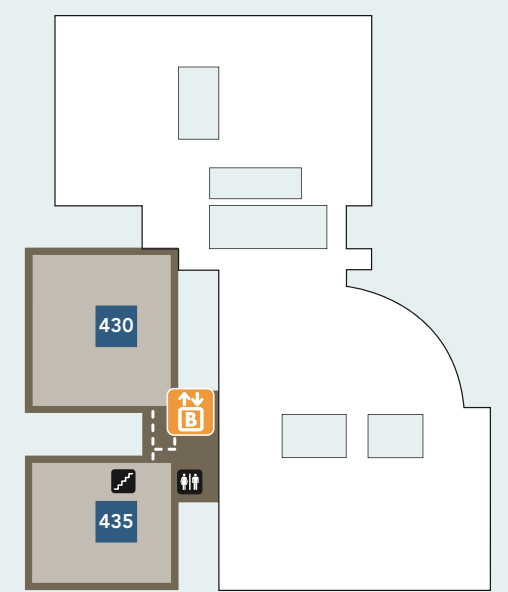

Hospital Basement

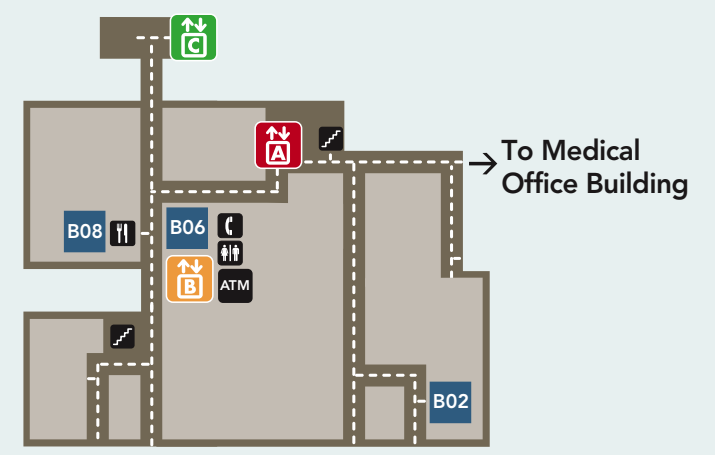

Department directory (alphabetical order)

- | | | |
|-----------------------------|----------------------------------|-----------------------------|
| 308 Administration | 323 Conference Room | 120 Nuclear Medicine |
| 112 Admitting | 100 Emergency | 204 Pathology |
| 114 Ambulatory Surgery | 106 Gift Gallery | 320 Pediatrics |
| B08 Cafeteria | 104 Imaging/Radiology | 138 Pharmacy/Discharge |
| 212 Cardiac Procedures Unit | 300 Labor and Delivery | 104 Radiology/Imaging |
| B06 Conference Room | 206 Laboratory – FNA Clinic | 310 Respiratory Therapy |
| 125 Conference Room | B02 Lost and Found | B02 Security |
| 225 Conference Room | 312 Medical Social Work | 200 Surgery/Operating Rooms |
| 238 Conference Room | 228 Meditation Room | 110 Volunteer Services |
| 304 Conference Room | 122 MRI | |
| 306 Conference Room | 302 Neonatal Intensive Care Unit | |

Patient room directory (numerical order)

- | | | |
|---|------------------------------------|--|
| 126 Intensive Care Unit Rooms 1260–1269 | 235 Surgical Unit Rooms 2350–2372 | 325 Pediatric Intensive Care Rooms 3250–3257 |
| 128 Stepdown Unit Rooms 1280–1289 | 300 Labor and Delivery | 330 Medical/Oncology Rooms 3300–3323 |
| 135 Medical Unit Rooms 1350–1372 | 300 Mother/Baby Unit Rooms 13–40 | 335 Medical/Surgical Rooms 3350–3372 |
| 220 Transitional Care Rooms 2200–2227 | 302 Neonatal Intensive Care | 430 Medical/Neurology Rooms 4300–4323 |
| 230 Intensive Care Unit Rooms 2300–2309 | 320 Pediatric Unit Rooms 3200–3222 | 435 Surgical/Orthopedics Rooms 4350–4372 |
| 232 Intensive Care Unit Rooms 2320–2329 | | |

- ATM
- Cafeteria
- Department or Unit
- Elevators A
- Elevators B
- Elevators C
- Public path of travel
- Restrooms
- Stairs
- Telephones

Medical Office Building 710 Lawrence Expressway

Find your department name and number on the alphabetical list below. Then locate the department number on the floor map above. The first digit indicates the floor number.



Finding your way AT SANTA CLARA MEDICAL CENTER

- Hospital
- Emergency Department
- Medical Office Building
- Cancer Treatment Center



General Information

Information kiosks
Visit the information desks in the facility's first floor lobbies for "Finding Your Way" kiosks.

Our Web site
Go to kaisersantaclara.org for a campus map and driving directions.

Medical Center Operators
(408) 851-1000

Appointments and Advice
Appointments: 8:30 a.m.–10 p.m., every day
Advice: 24 hours, every day

- Internal Medicine (408) 554-9800
- Optometry (408) 554-9830
- Pediatrics (408) 554-9810
- Women's Clinics (408) 554-9820

Member Service Call Center
Call us with your benefits and billing questions.
Hours: M–F, 7 a.m.–7 p.m.;
Sa–Su, 7 a.m.–3 p.m.

- 1-800-464-4000 English
- 1-800-788-0616 Spanish
- 1-800-757-7585 Chinese dialects
- 1-800-777-1370 TTY for the hearing/speech impaired



Santa Clara Medical Center
Hospital, 700 Lawrence Expressway
Medical Office Building, 710 Lawrence Expressway
Santa Clara, CA 95051
(408) 851-1000

kaisersantaclara.org

Floor 1

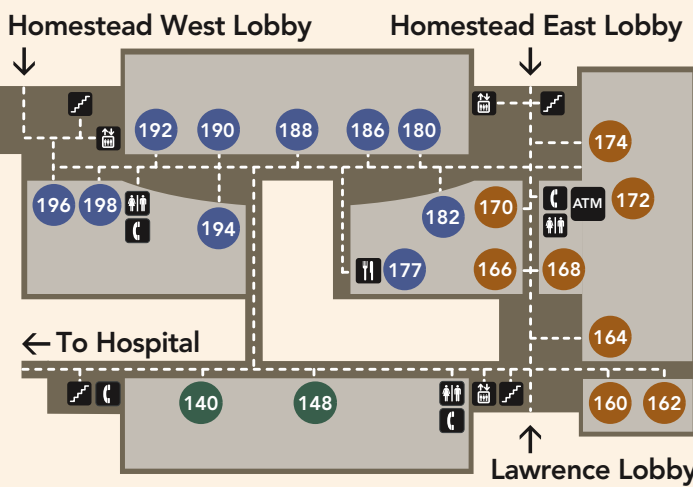

Floor 2

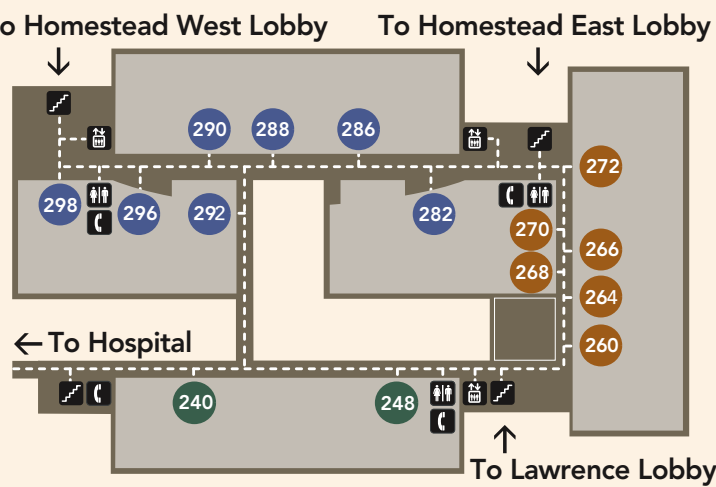

Floor 3

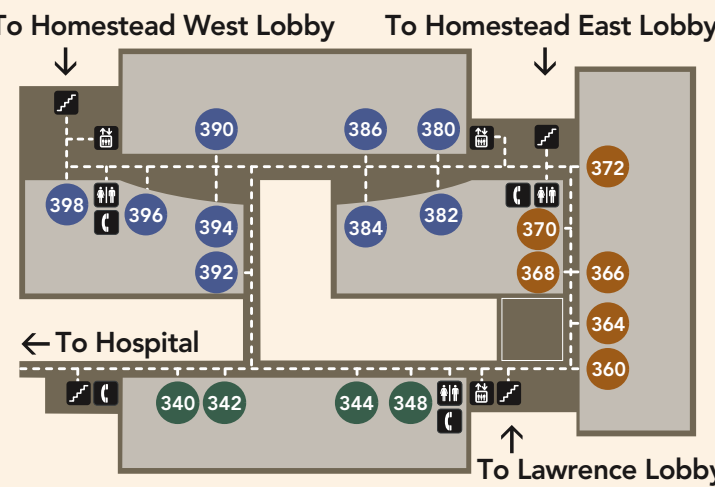

Floor 4

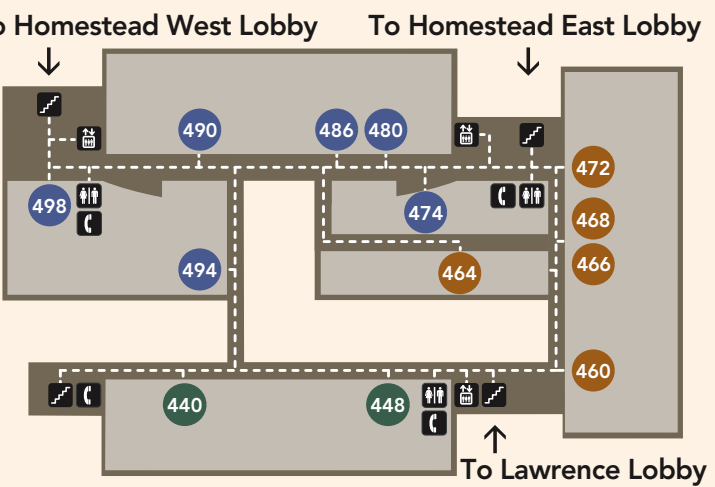

Department directory (alphabetical order)

- | | | | | | | | |
|-------------------------------------|-------------------------------|--------------------------------|----------------------------|---------------------------------|-------------------------------------|--|------------------------------|
| 398 Administration | 344 Classroom | 494 Eye Surgery Center | 188 Injections – Pediatric | 460 Neurology | 186 Pediatrics | 282 Pulmonary Medicine | 290 Vascular Surgery |
| 498 Administration | 366 Classroom | 260 Evening and Weekend Clinic | 260 Internal Medicine | 180 Newborn Club | 190 Pediatrics | Rehabilitation Services (Physical, Occupational, and Speech Therapy) | 164 Volunteer Services |
| 160 Business Office | 380 Classroom | 248 GI/Gastroenterology | 272 Internal Medicine | 198 Nutritional Counseling | 340 Perinatology | 174 | 390 Women's Clinic |
| 460 CAPD/Peritoneal Dialysis Center | 392 Classroom | 166 Gift Gallery | 360 Internal Medicine | 440 Oncology/Hematology | 460 Peritoneal Dialysis Center/CAPD | 248 Spine Clinic | 386 Women's Clinic |
| 348 Cardiology | 466 Classroom | 384 Graduate Medical Education | 372 Internal Medicine | 490 Ophthalmology/Eye Care | 194 Pharmacy | 384 Staff Educational Services | 394 Women's Health Education |
| 342 Cardiovascular Services | 468 Classroom | 464 HARC | 382 IT Training | 474 Optical Services | 170 Pharmacy | 286 Surgery Clinic | 396 Women's Imaging |
| 472 Chronic Conditions Management | 480 Classroom | 182 Health Education | 168 Laboratory | 486 Optometry/Eye Care | 270 Pharmacy | 448 Urology | 290 Wound Care |
| 172 Classroom | 196 Conference Center | 298 Health Sciences Library | 268 Laboratory | 148 Orthopedics/Sports Medicine | 370 Pharmacy | | |
| 192 Classroom | 177 Courtyard Café ☺ | 292 Human Resources | 290 Maxillofacial Surgery | 240 Outpatient Procedure Center | 290 Plastic Surgery | | |
| 264 Classroom | 472 Dermatology | 382 Information Technology | 162 Member Services | 160 Patient Records | 140 Podiatry | | |
| 266 Classroom | 364 Employee Health | 440 Infusion Center | 160 Member Outreach | 162 Patient Relations | 282 Preoperative Clinic | | |
| 288 Classroom | 296 ENT/Head and Neck Surgery | 368 Injections – Adult | 460 Nephrology | | | | |

ATM	Restrooms
☺ Café	Stairs
Elevator	Telephones
Public path of travel	

Information desks are located on the 1st floor in the lobbies.